

NOTE: external controller included (LPA-SMC)

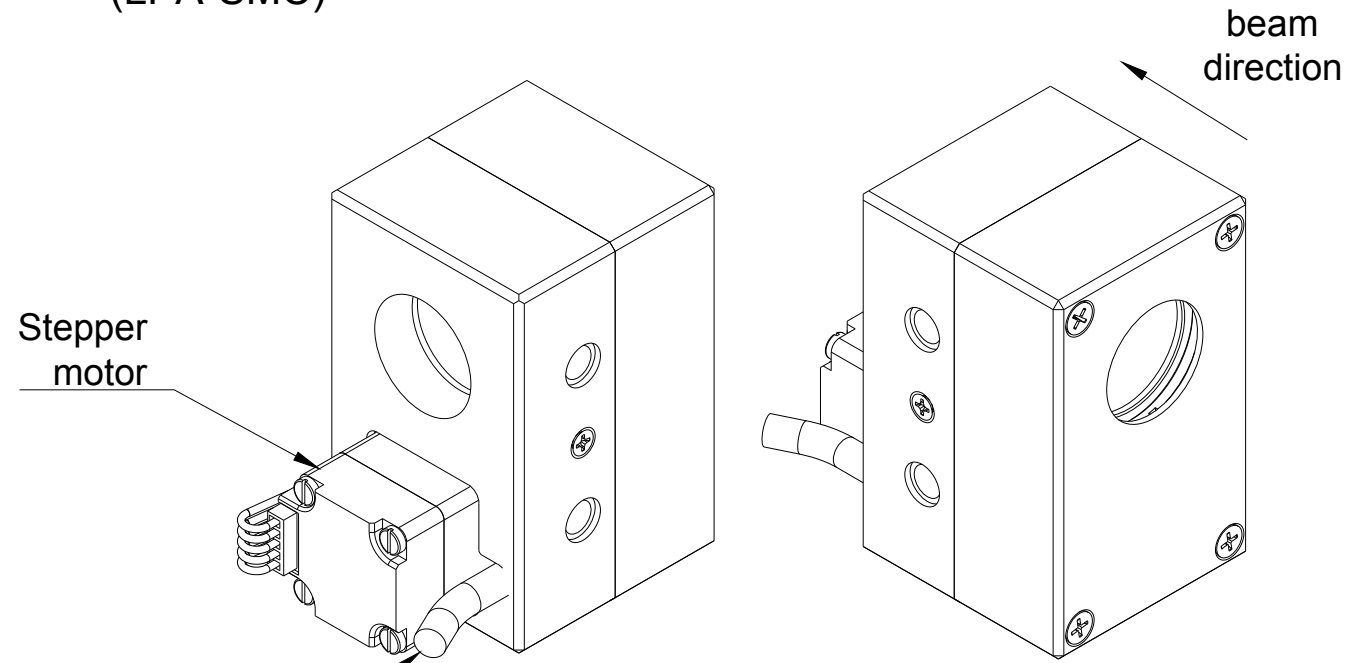

Stepper motor
Cable to SMC controller

Front view

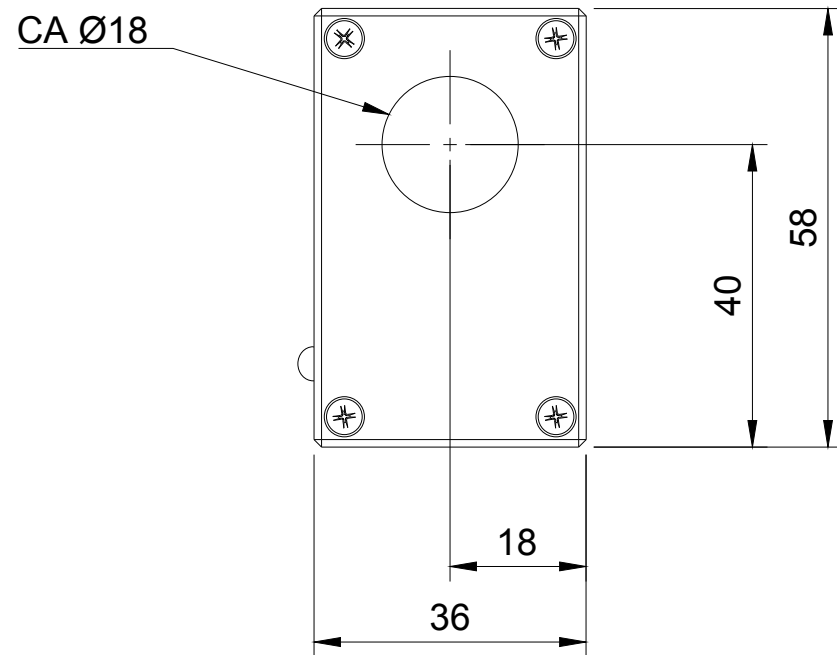

Bottom view

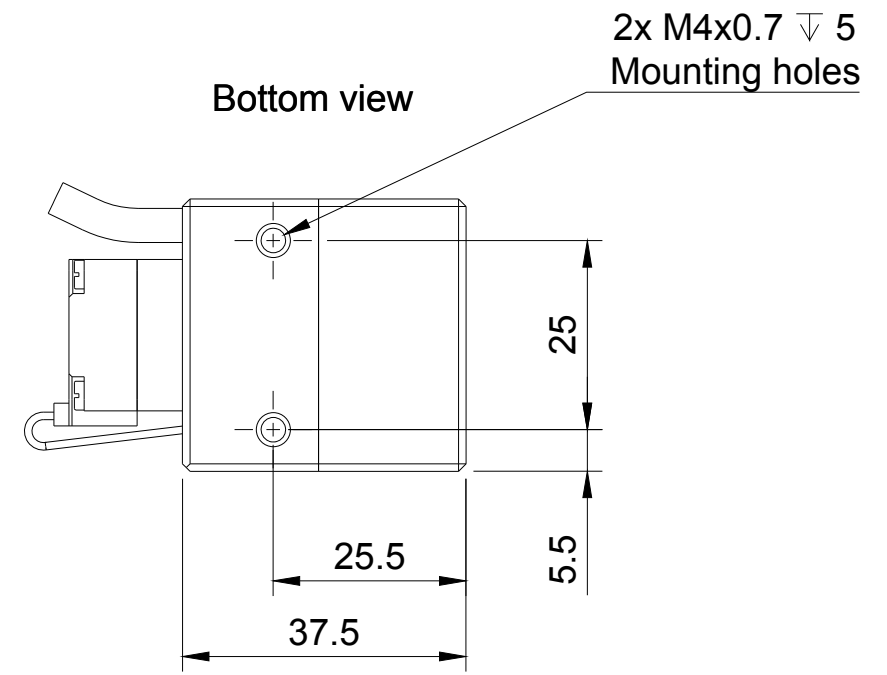

2x M4x0.7 ∇ 5
Mounting holes

Side view

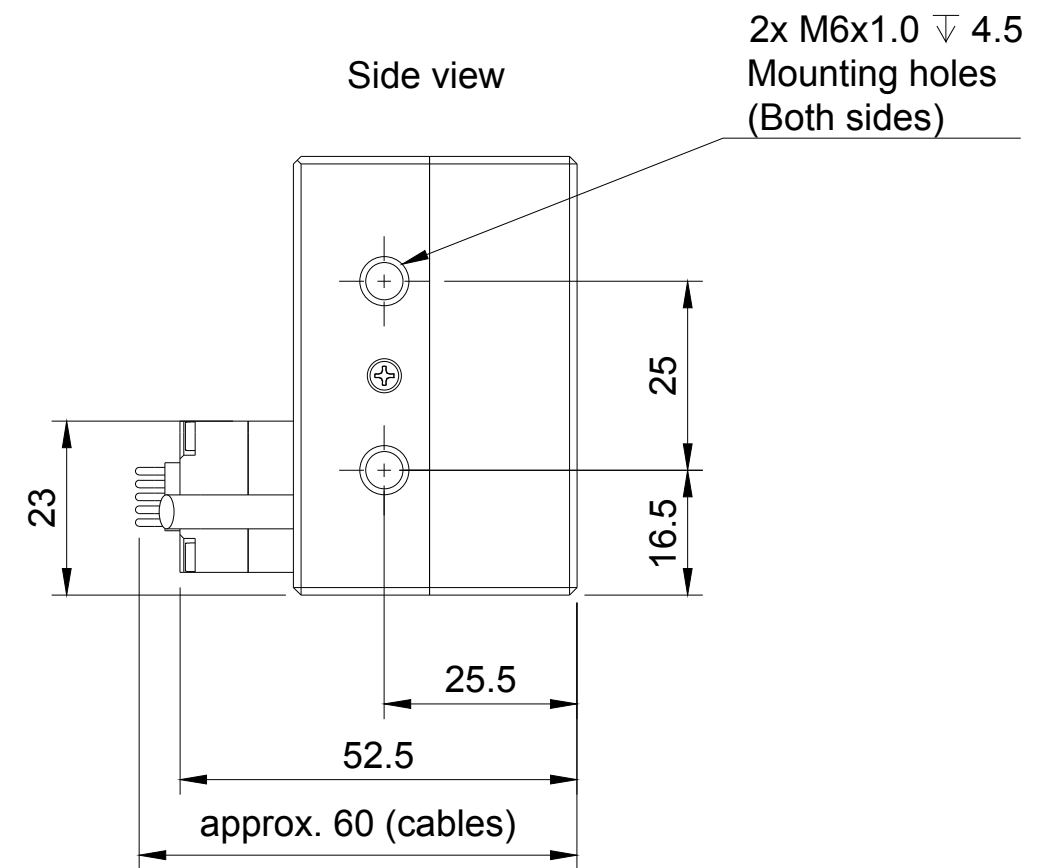

2x M6x1.0 ∇ 4.5
Mounting holes
(Both sides)

NOTE: Natural anodized for UV
Black anodized for VIS and NIR

! FOR INFORMATION ONLY
NOT FOR MANUFACTURING PURPOSES **!**



Finish
Anodized Aluminium

Title
Rotator v1.2

Created by
Optogama 2021-09-28

DWG No.
ROTV1.2

Scale
1:1

A3

Sheet
1/1